



No. 3

Do - It - Yourself Solutions

Repairing an old plaster ceiling



What you will need for the job



DIY Total Joint Finish
DIY Cornice Adhesive
DIY Trimming Knife
DIY Plasterboard Nails
DIY Paper Jointing Tape
(Do not use Fibreglass Tape)
DIY 150mm Broad Knife
DIY Hand Sander
DIY Dust Mask
DIY Sandpaper 150 Grit
DIY Plasterboard Screws
*Refer to Boral
Plasterboard DIY
Worksheets No.s 6 & 7*

Other

Boral Plasterboard Sheet
Small Screwdriver
Screw Gun (recommended)
or Cordless Drill
Rondo Metal Battens
(suitable length/gauge)
Boral Plasterboard Cove
Cornice
Plasterboard Lifter (Hire)



How to repair an old plaster ceiling

Safety First - Organise an Electrician

Have an electrician isolate electric light fittings.

Removing the old cornice

- 1 Carefully score along the bottom edge of the existing cornice with the trimming knife.
- 2 Remove the cornice by levering it away from where the wall joins the ceiling with a flat instrument such as a paint scraper, taking care not to damage the wall surface.

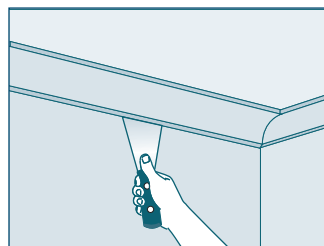

Preparation

- 1 Locate the centre points of existing ceiling joists by probing with a small screwdriver.
- 2 Prop up and re-nail or screw fasten any badly sagging parts of the ceiling (screw fastening creates less vibration).

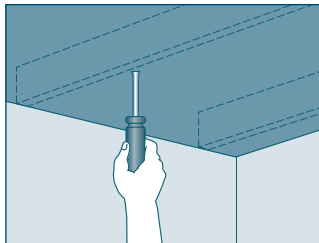

Fixing battens

- 1 Attach metal battens at right angles to existing ceiling joists.
- 2 Fix battens to each joist with flathead nails or appropriately sized nails to suit batten type and ceiling construction. Screws should also be considered in order to lessen vibration.
- 3 Space battens at 450mm maximum centres if using 10mm plasterboard.

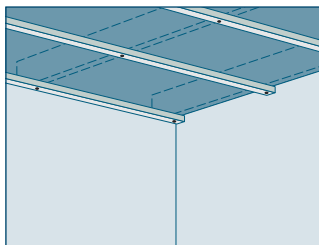

Rondo Batten No. 301

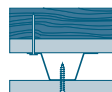

Rondo Batten No. 303

Positioning plasterboard sheets

- 1 Position plasterboard sheets across battens. (It is highly recommended that you use full size sheets to avoid complex butt joints.)
- 2 Two people will be needed to lift plasterboard ceiling sheets into position, or better still - hire a plasterboard lifter.

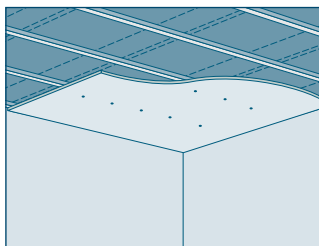

Fixing plasterboard sheets

- 1 Using a screw gun, fasten the plasterboard sheets to the metal battens with plasterboard screws spaced every 300mm maximum centres (approx. 5 screws per batten). For 1350mm wide sheets use 6 screws.
- 2 Always screw from the centre of the plasterboard sheet towards the outside edge.

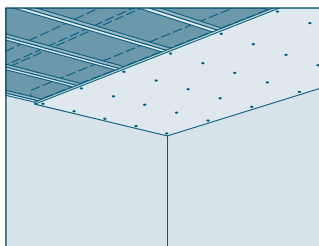

- 3 Always drive screws with the shank at right angles to the sheet face (straight up).
- 5 Be sure the screw gun is correctly adjusted, so that the screw heads are driven just below the plasterboard surface without breaking the paper face.
- 4 Press tip of screw firmly into plasterboard linerboard face before commencing to drive the screw.

Finishing

- 1 Finish joints with Boral Paper Jointing Tape and DIY Total Joint Finish.
(Refer to Boral Plasterboard DIY Worksheet No.6 – Jointing and finishing.)
- 2 After repairing the old ceiling, fix new lengths of cornice around the perimeter of the room using DIY Boral Plasterboard Cornice Adhesive. *(Refer to Boral Plasterboard DIY Worksheet No.7 – Installing Cornice.)*

Health & Safety

- 1 Do not ingest contents of product packaging. If ingested, seek medical advice. 
- 3 If dust or paste causes skin irritation, use impervious PVC, Nitrite or Rubber gloves.
- 4 Keep contents out of reach of children. 
- 2 Avoid creating dust when handling, mixing or sanding as dust from packaged products may contain crystalline silica. Repeated inhalation of silica dust over long periods of time may lead to bronchitis, silicosis or cancer. If dust is unavoidable, ensure adequate ventilation, wear eye protection and an approved disposable face mask that conforms to Australian Standards AS 1716 Type P1 or P2.

Contact Information

In Emergencies call 1800 033 011, Poison Information on 13 11 261

Note: If you don't feel confident enough to take on this project, contact your local Boral Plasterboard sales outlet for a list of competent contractors in your area.

For further technical assistance or more information on Boral Plasterboard DIY products, please contact TecASSIST 1800 811 222 or your local Boral Plasterboard sales office:

QLD 07 3215 2244
TAS 03 6278 9966
NSW 02 9638 0571

SA 08 8240 8888
ACT 02 6280 4243
NT 08 8984 4484

VIC 03 9214 2138
WA 08 9400 2666

Boral Australian Gypsum Limited
A.C.N. 004 231 976
676 Lorimer St, Port Melbourne Vic 3207
<http://www.boral.com.au>

 is a registered trademark of Boral Plasterboard.

September 2003
Products Systems Solutions

